

TOTAL AREA

95.4 Sqm 1026 Sqft

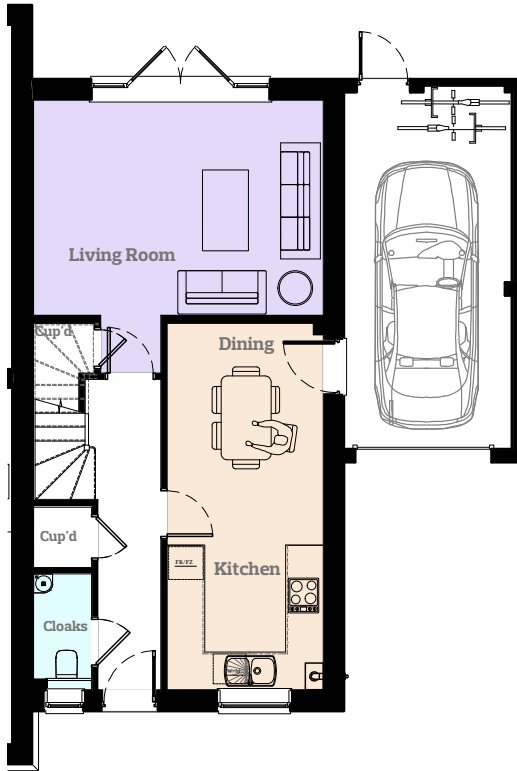

GROUND FLOOR

| | |
|--------------------|------------------------------|
| Living | 4843 x 4560mm 15.9 x 15ft |
| Kitchen/ Dining | 2611 x 6125mm 8.6 x 20ft |
| WC | 969 x 1937mm 3.2 x 6.4ft |



FIRST FLOOR

| | |
|-------------------|--------------------------------|
| Bed 1 | 3873 x 4105mm 12.7 x 13.5ft |
| Bed 1 En-Suite | 1044 x 3052mm 3.4 x 10ft |
| Bed 2 | 2661 x 3592mm 8.7 x 11.8ft |
| Bed 3 | 2070 x 2634mm 6.8 x 8.6ft |
| Bathroom | 2661 x 1915mm 8.7 x 6.3ft |

KEY

 Roof Access Panel

 Boiler